

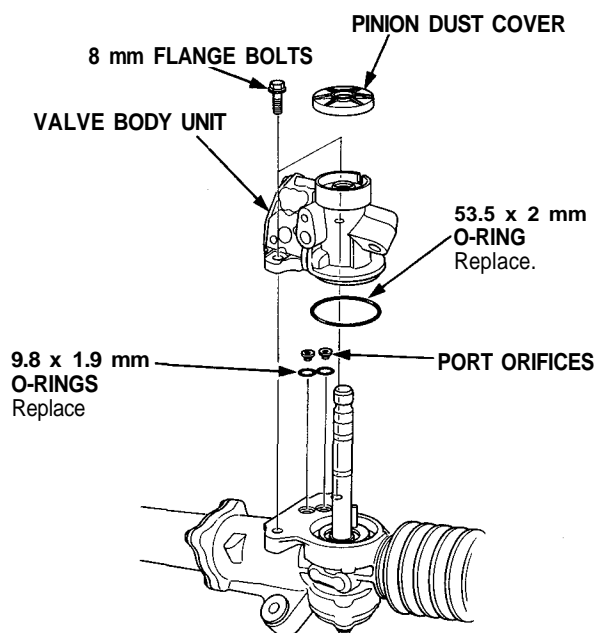

Valve Body Unit Overhaul

1. Remove the steering gearbox (see page 17-41).
2. Remove the pinion dust cover.
3. Remove the two 8 mm flange bolts and remove the valve body unit from the gearbox.
4. Remove the O-rings and orifices from the gearbox.



5. Remove the pinion dust seal.

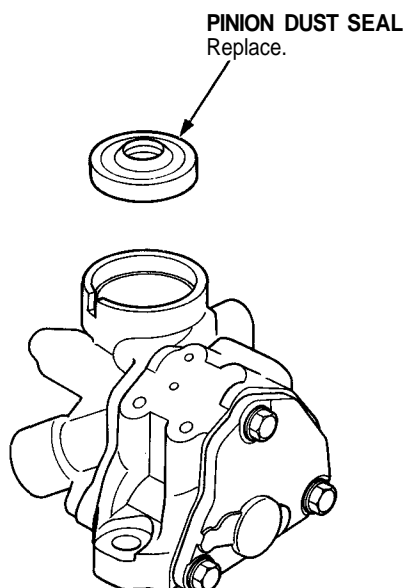

6. Remove the three 6 mm flange bolts, and remove the valve body cap from the valve body.
7. Remove the cap seal from the cap.

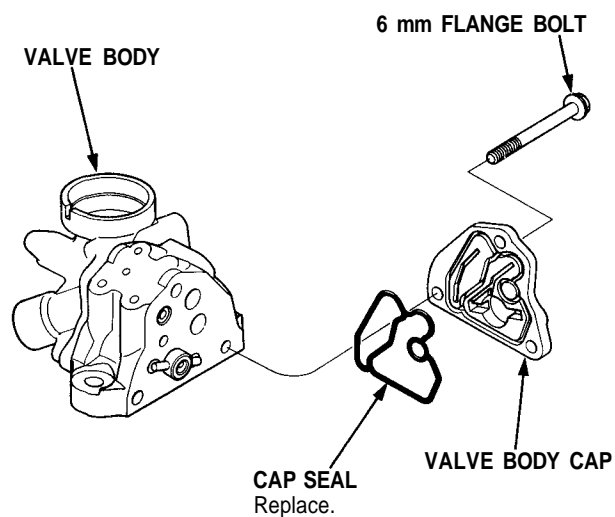

8. Remove the pressure control valve and spring from the valve body.

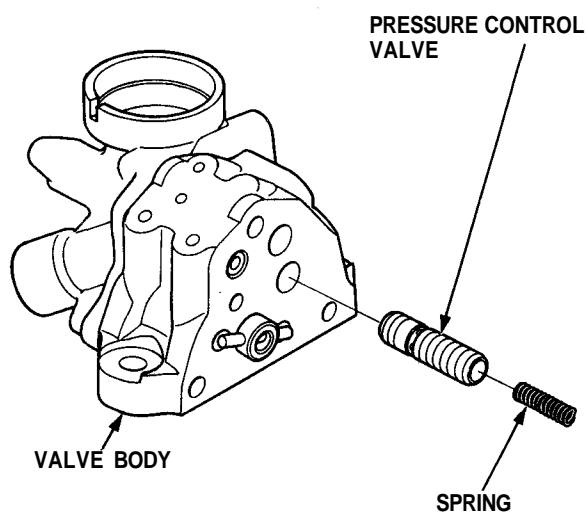

(cont'd)

Steering Gearbox

Valve Body Unit Overhaul (cont'd)

9. Check the pressure control valve:

- Inspect its surface for scoring or scratches.
- Slip it back into the valve body, and make sure it slides smoothly without drag and without side play.

NOTE: If any part of the valve body is damaged, replace the valve body unit (valve body, pressure control valve, gain control valve, 4-way valve) as an assembly.

PRESSURE CONTROL VALVE

Check for scoring or scratches, and rough operation.

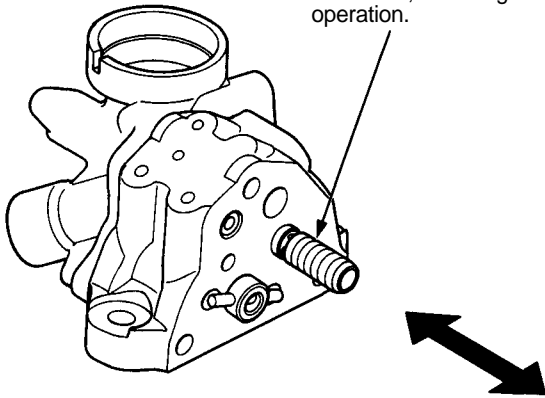

10. Remove the gain control valve and spring from the valve body.

GAIN CONTROL VALVE

SPRING

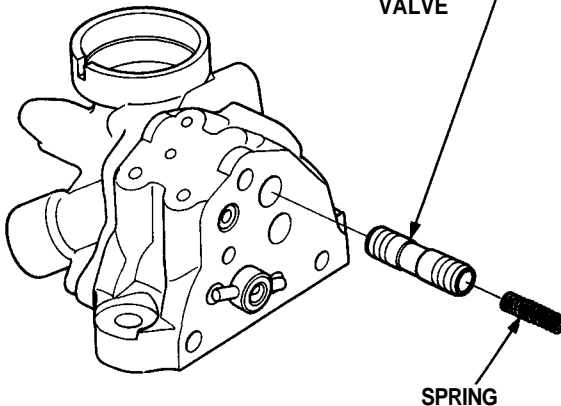

11. Check the gain control valve:

- Inspect its surface for scoring or scratches.
- Slip it back into the valve body and make sure it slides smoothly without drag and without side play.

NOTE: If any part of the valve body is damaged, replace the valve body unit (valve body, pressure control valve, gain control valve, 4-way valve) as an assembly.

GAIN CONTROL VALVE

Check for scoring scratches, or rough operation.

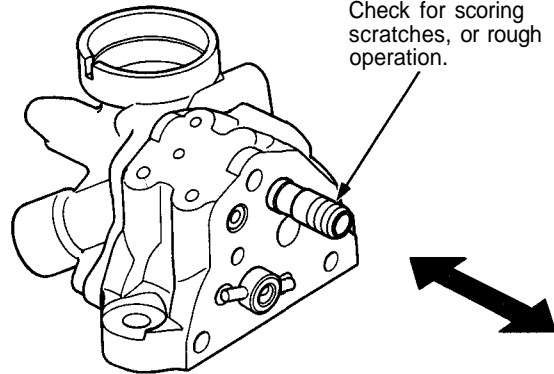

12. Separate the valve body and port housing.

13. Remove the port seal and dowel pins from the port housing.

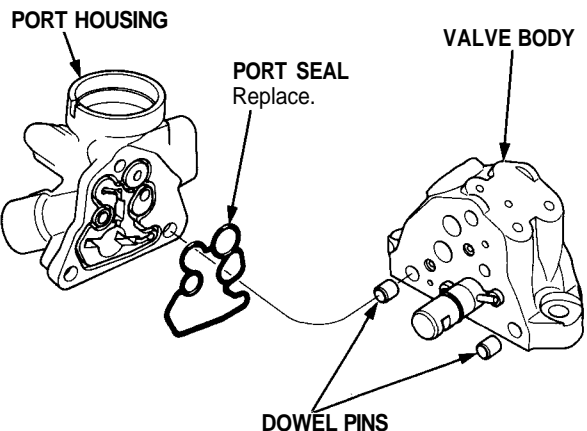



14. Using 1.5 mm (0.06 in) drill bit, remove the sensor orifice and 3.4 mm O-ring.

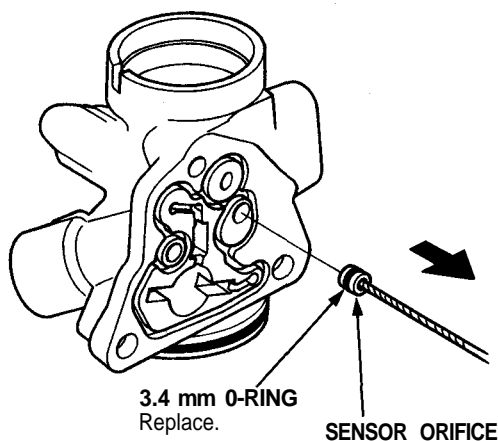

15. Remove the rollers from the 4-way valve by pushing the valve out one side of the valve body, and then the other.

NOTE: When removing the rollers, hold the plungers with your fingers to keep them from popping out.

16. Remove the plungers, return springs and 4-way valve from the valve body.

17. Remove the 11 mm O-ring from the 4-way valve.

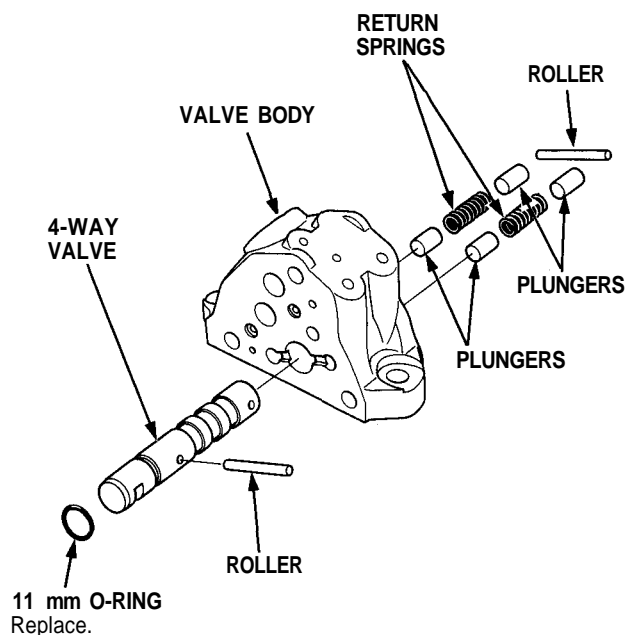

18. Check the plungers.

- Inspect their surface for scoring or scratches.
- Slip each plunger into the valve body. Make sure it slides smoothly, without drag or side play. If any plunger is damaged, replace it.

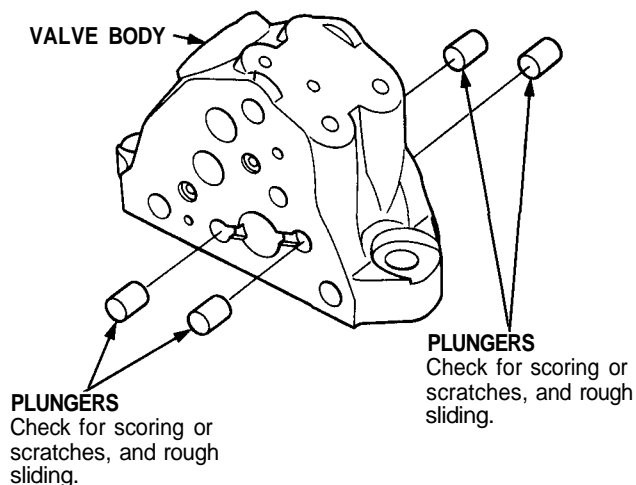

19. Check the 4-way valve.

- Inspect its surface for scoring or scratches.
- Slip it into the valve body, and make sure it slides smoothly, without drag or side play.

NOTE: If any part of the valve body is damaged, replace the valve body unit (valve body, pressure control valve, gain control valve, 4-way valve) as an assembly.

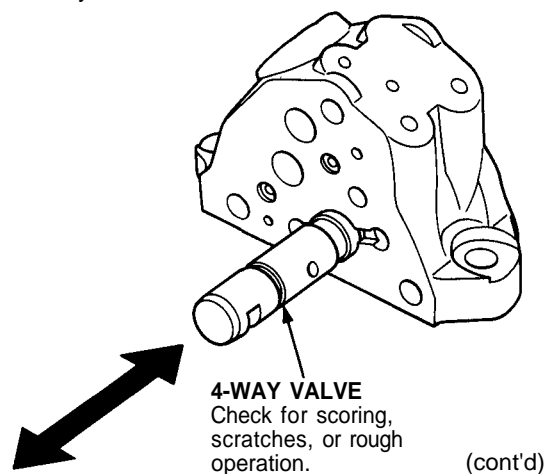

Steering Gearbox

Valve Body Unit Overhaul (cont'd)

Assembly:

1. Thoroughly clean the disassembled parts shown below.
2. Coat the plungers, pressure control valve, gain control valve and 4-way valve surfaces with power steering fluid.
3. Reassemble the parts in the reverse order of disassembly.

CAUTION:

- Replace the O-rings and seals with new ones.
 - Do not dip the O-rings and seals in solvent.
 - Apply grease in the seal grooves to keep the seals in place.
 - Apply grease to new O-rings to keep them in place.
-  : STEERING GREASE (Part Number 08733 — B070E)

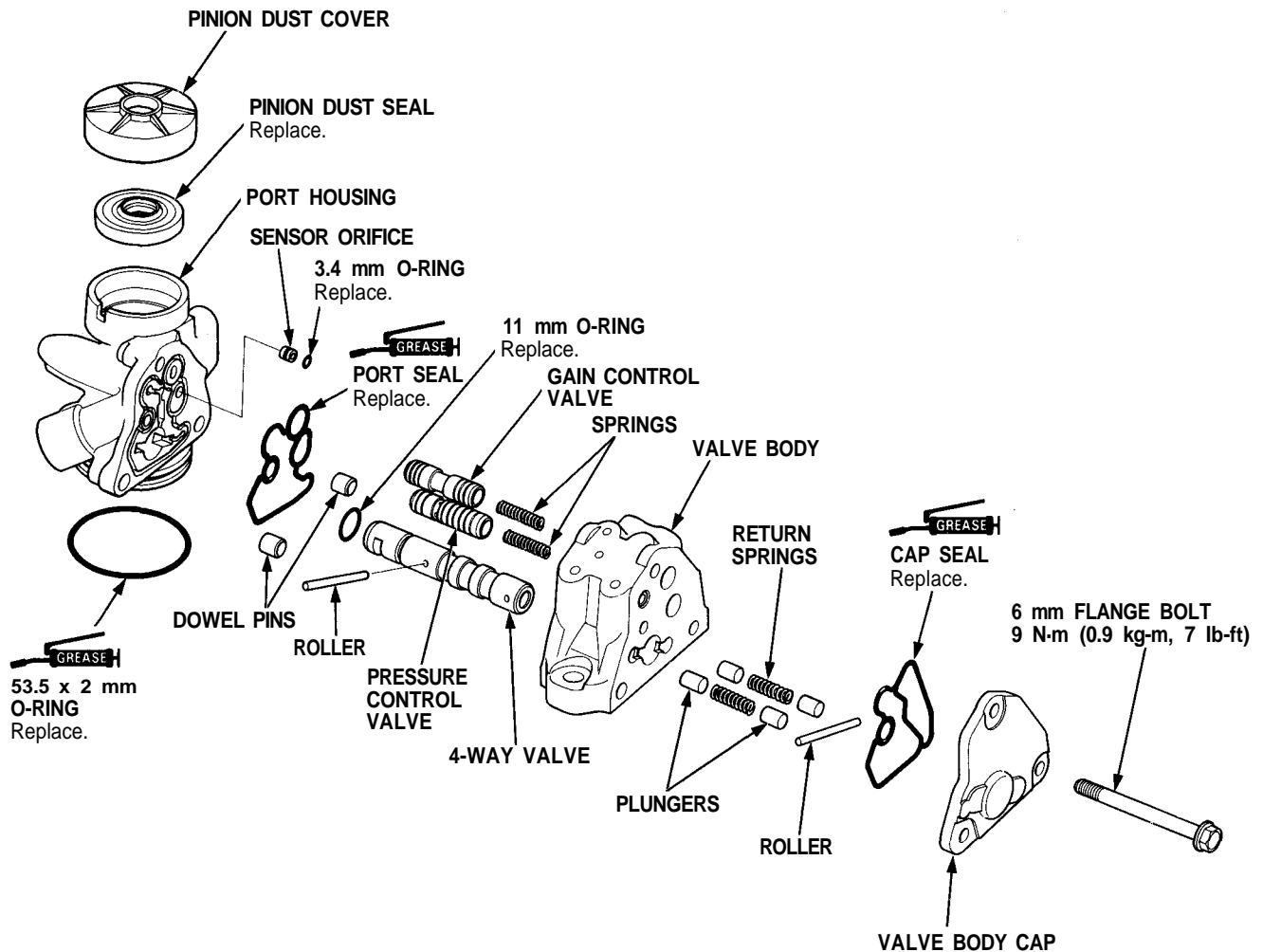

NOTE: If the valve body is damaged, replace the valve body unit (valve body, pressure control valve, gain control valve, 4-way valve) as an assembly.



4. Make sure the 4-way valve moves smoothly, and returns to neutral position.

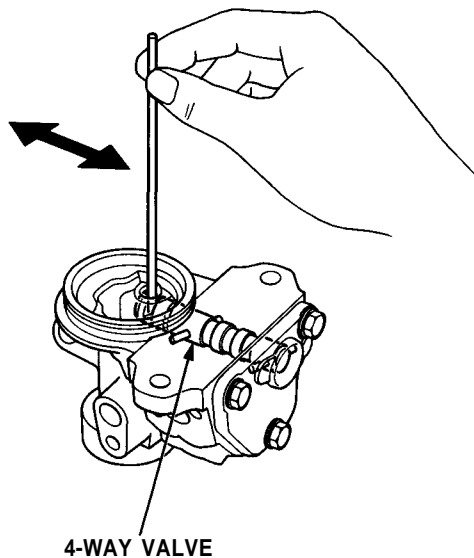

5. Install the new pinion dust seal in the valve body unit by hand.

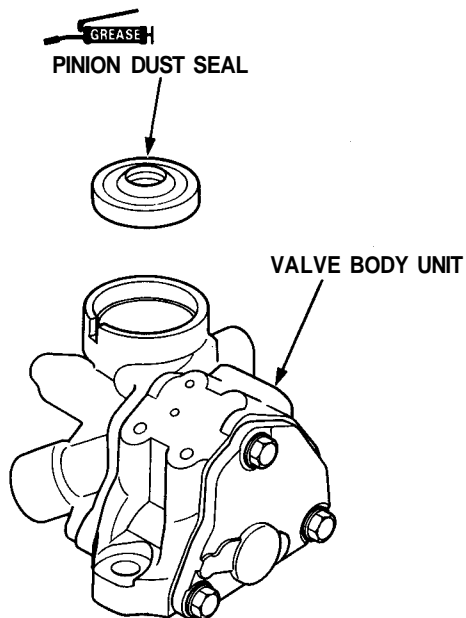

6. Coat the 9.8 x 1.9 mm O-rings with power steering fluid, and install them together with the orifices.
7. Apply vinyl tape to the pinion shaft and coat the vinyl tape with grease.
8. Coat the 53.5 x 2 mm O-ring and pinion holder pin with grease, and install the valve body unit.
9. Install the valve body unit on the gear housing with the two 8 mm flange bolts.

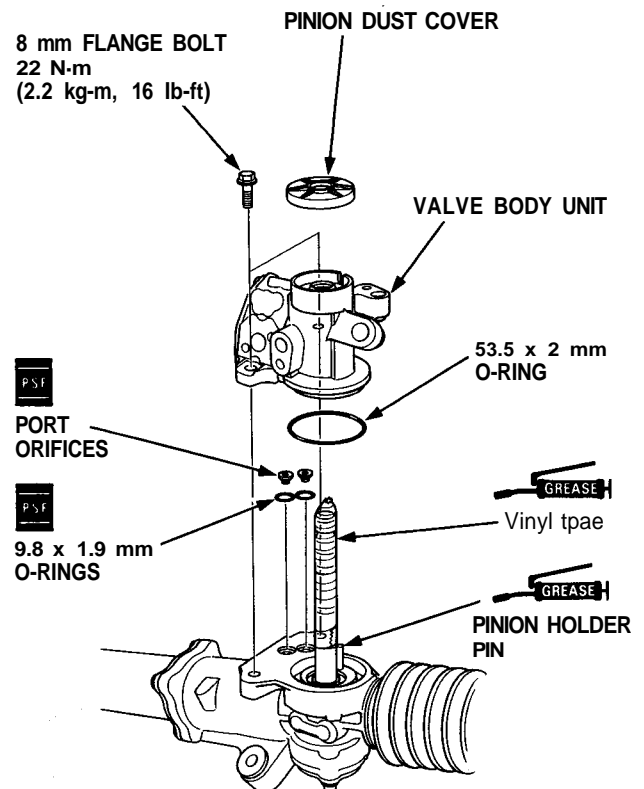

10. Remove the vinyl tape.

CAUTION:

- When installing, be careful not to hit the pinion holder pin.
- Make sure the O-rings are in place and not pinched.